

Customer approval :

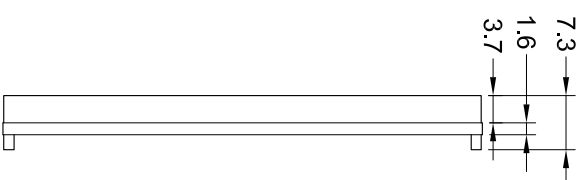
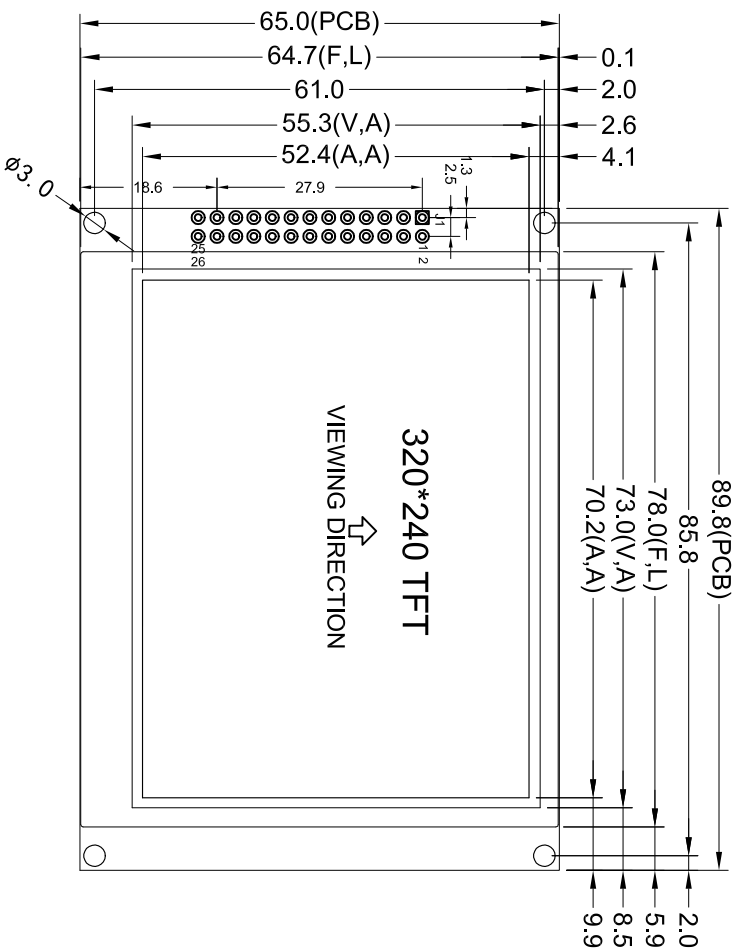

NO.	SYMBOL	J1
1	VSS	
2	VDD	
3	NC	
4	WR	
5	RD	
6	CS/SDI	
7	A0/SCL	
8	RESET	
9	D0/SSDO	
10	D1/SCS	
11	D2	
12	D3	
13	D4	
14	D5	
15	D6	
16	D7	
17	D8	
18	D9	
19	D10	
20	D11	
21	D12	
22	D13	
23	D14	
24	D15	
25	INT	
26	WATT	

Specification:

- 1). Driving: VDD: 5.0V & 3.3V
- 2). Viewing direction: 12 o'clock
- 3). Display mode: TFT 320*240 65K Colour
- 3). Operating temp.: -20°C ~ +70°C
- 4). Storage temp.: -30°C ~ +80°C
- 5). Control IC: RA8875
- 6). Backlight : VBL: 5.0V & 3.3V
- 7). All the raw materials are RoHS compliant
- 8). Interface: 8Bit 16Bit 8080/6800, SPI, I2C;

REV	REVISION RECORD	DATE	MODEL NO.	CHECKED BY	DRAWING BY	PAGE:	UNIT:
A	FIRST ISSUE	2016/04/22	模组型号	审核	绘图	1 OF 1	mm
B			SYC320240A035V11	检查	Luoxian		
C			APPROVED BY	审核	Luoxian		
D			2016/04/22	Liu	Luoxian		



深圳市三元晶科技有限公司
ShenZhen TCC LCD HI-Tech Co., Ltd.

GENERAL TOL: ± 0.3
未注公差

